



Bid Number/बोली क्रमांक (बिड संख्या):
GEM/2024/B/4761669
Dated/दिनांक : 19-03-2024

Bid Document/ बिड दस्तावेज़

Bid Details/बिड विवरण	
Bid End Date/Time/बिड बंद होने की तारीख/समय	19-04-2024 15:00:00
Bid Opening Date/Time/बिड खुलने की तारीख/समय	19-04-2024 15:30:00
Bid Offer Validity (From End Date)/बिड पेशकश वैधता (बंद होने की तारीख से)	120 (Days)
Ministry/State Name/मंत्रालय/राज्य का नाम	Ministry Of Finance
Department Name/विभाग का नाम	Department Of Economic Affairs
Organisation Name/संगठन का नाम	Security Printing And Minting Corporation Of India Limited (spmcl)
Office Name/कार्यालय का नाम	Janpath
Item Category/मद केटगरी	Custom Bid for Services - Hiring an agency to supply and installation of material for renovation of HRD center
Contract Period/अनुबंध अवधि	3 Month(s)
MSE Exemption for Years Of Experience/अनुभव के वर्षों से एमएसई छूट/ and Turnover/टर्नओवर के लिए एमएसई को छूट प्राप्त है	Yes
Startup Exemption for Years Of Experience/अनुभव के वर्षों से स्टार्टअप छूट/ and Turnover/ टर्नओवर के लिए स्टार्टअप को छूट प्राप्त है	Yes
Document required from seller/विक्रेता से मांगे गए दस्तावेज़	Experience Criteria,Certificate (Requested in ATC),OEM Authorization Certificate,Additional Doc 1 (Requested in ATC),Additional Doc 2 (Requested in ATC),Additional Doc 3 (Requested in ATC) *In case any bidder is seeking exemption from Experience / Turnover Criteria, the supporting documents to prove his eligibility for exemption must be uploaded for evaluation by the buyer
Bid to RA enabled/बिड से रिवर्स नीलामी सक्रिय किया	No
Type of Bid/बिड का प्रकार	Two Packet Bid
Time allowed for Technical Clarifications during technical evaluation/तकनीकी मूल्यांकन के दौरान तकनीकी स्पष्टीकरण हेतु अनुमत समय	2 Days
Evaluation Method/मूल्यांकन पद्धति	Total value wise evaluation

Bid Details/बिड विवरण**Financial Document Indicating Price****Breakup Required/मूल्य दर्शाने वाला वित्तीय दस्तावेज**

ब्रेकअप आवश्यक है

Yes

EMD Detail/ईएमडी विवरण

Advisory Bank/एडवाइजरी बैंक

Indusind bank

EMD Amount/ईएमडी राशि

42500

ePBG Detail/ईपीबीजी विवरण

Advisory Bank/एडवाइजरी बैंक

Indusind bank

ePBG Percentage(%) / ईपीबीजी प्रतिशत (%)

5.00

Duration of ePBG required (Months) / ईपीबीजी की अपेक्षित अवधि (महीने).

17

(a). EMD EXEMPTION: The bidder seeking EMD exemption, must submit the valid supporting document for the relevant category as per GeM GTC with the bid. Under MSE category, only manufacturers for goods and Service Providers for Services are eligible for exemption from EMD. Traders are excluded from the purview of this Policy./जेम की शर्तों के अनुसार ईएमडी छूट के इच्छुक बिडर को संबंधित कैटेगरी के लिए बिड के साथ वैध समर्थित दस्तावेज प्रस्तुत करने हैं। एमएसई कैटेगरी के अंतर्गत केवल वस्तुओं के लिए विनिर्माता तथा सेवाओं के लिए सेवा प्रदाता ईएमडी से छूट के पात्र हैं। व्यापारियों को इस नीति के दायरे से बाहर रखा गया है।

(b). EMD & Performance security should be in favour of Beneficiary, wherever it is applicable./ईएमडी और संपादन जमानत राशि, जहां यह लागू होती है, लाभार्थी के पक्ष में होनी चाहिए।

Beneficiary/लाभार्थी :

Narmadapuram

Security Paper Mill, Narmadapuram

(Security Paper Mill)

Splitting/विभाजन

Bid splitting not applied/बोली विभाजन लागू नहीं किया गया.

MII Compliance/एमआईआई अनुपालन

MII Compliance/एमआईआई अनुपालन

Yes

MSE Purchase Preference/एमएसई खरीद वरीयता

MSE Purchase Preference/एमएसई खरीद वरीयता

Yes

1. If the bidder is a Micro or Small Enterprise as per latest definitions under MSME rules, the bidder shall be exempted from the requirement of "Bidder Turnover" criteria and "Experience Criteria" subject to meeting of quality and technical specifications. If the bidder is OEM of the offered products, it would be exempted from the "OEM Average Turnover" criteria also subject to meeting of quality and technical specifications. In case any bidder is seeking exemption from Turnover / Experience Criteria, the supporting documents to prove his eligibility for exemption must be uploaded for evaluation by the buyer.

2. If the bidder is a Startup, the bidder shall be exempted from the requirement of "Bidder Turnover" criteria and "Experience Criteria" subject to their meeting of quality and technical specifications. If the bidder is OEM of the offered products, it would be exempted from the "OEM Average Turnover" criteria also subject to meeting of quality and technical specifications. In case any bidder is seeking exemption from Turnover / Experience Criteria, the supporting documents to prove his eligibility for exemption must be uploaded for evaluation by the buyer.

3. Purchase preference to Micro and Small Enterprises (MSEs): Purchase preference will be given to MSEs as defined in Public Procurement Policy for Micro and Small Enterprises (MSEs) Order, 2012 dated 23.03.2012 issued by Ministry of Micro, Small and Medium Enterprises and its subsequent Orders/Notifications issued by concerned Ministry. If the bidder wants to avail the Purchase preference for services, the bidder must be the Service provider of the offered Service. Relevant documentary evidence in this regard shall be uploaded along with the bid in respect of the offered service. If L-1 is not an MSE and MSE Service Provider (s) has/have quoted price within L-1+ 15% of margin of purchase preference /price band defined in relevant policy, then 100% order quantity will be awarded to such MSE bidder subject to acceptance of L1 bid price.

OM No.1 4 2021 PPD dated 18.05.2023 for compliance of Concurrent application of Public Procurement Policy for Micro and Small Enterprises Order, 2012 and Public Procurement (Preference to Make in India) Order, 2017.

4. Estimated Bid Value indicated above is being declared solely for the purpose of guidance on EMD amount and for determining the Eligibility Criteria related to Turn Over, Past Performance and Project / Past Experience etc. This has no relevance or bearing on the price to be quoted by the bidders and is also not going to have any impact on bid participation. Also this is not going to be used as a criteria in determining reasonableness of quoted prices which would be determined by the buyer based on its own assessment of reasonableness and based on competitive prices received in Bid / RA process.

Additional Qualification/Data Required/अतिरिक्त योग्यता /आवश्यक डेटा

Scope of Work:[1710133814.pdf](#)

Service Level Agreement (SLA):[1710133823.pdf](#)

Payment Terms:[1710133831.pdf](#)

GEM Availability Report (GAR):[1710133837.pdf](#)

Any other Documents As per Specific Requirement of Buyer -1:[1710133848.pdf](#)

Buyers are requested to upload the format for price breakup of the lumpsum offering to be provided by the service provider (Please provide the format if financial upload required is selected as "Yes" while creating Bid):[1710133850.pdf](#)

Custom Bid For Services - Hiring An Agency To Supply And Installation Of Material For Renovation Of HRD Center (1)

Technical Specifications/तकनीकी विशिष्टियाँ

Specification	Values
Core	
Description /Nomenclature of Service Proposed for procurement using custom bid functionality	Hiring an agency to supply and installation of material for renovation of HRD center
Regulatory/ Statutory Compliance of Service	YES
Compliance of Service to SOW, STC, SLA etc	YES

Specification	Values
Addon(s)/एडऑन	

Additional Specification Documents/अतिरिक्त विशिष्टि दस्तावेज़

Consignees/Reporting Officer/परेषिती/रिपोर्टिंग अधिकारी

S.No./क्र. सं.	Consignee Reporting/Officer/ परेषिती/रिपोर्टिंग अधिकारी	Address/पता	The quantity of procurement "1" indicates Project based or Lumpsum based hiring.	Additional Requirement/अतिरिक्त आवश्यकता
1	Balbir Singh Prajapati	461005, Security Paper Mill ,Narmadapuram , Madhya Pradesh	1	N/A

Buyer Added Bid Specific Terms and Conditions/क्रेता द्वारा जोड़ी गई बिड की विशेष शर्तें

1. Generic

Manufacturer Authorization: Wherever Authorised Distributors/service providers are submitting the bid, Authorisation Form /Certificate with OEM/Original Service Provider details such as name, designation, address, e-mail Id and Phone No. required to be furnished along with the bid

2. Certificates

Bidder's offer is liable to be rejected if they don't upload any of the certificates / documents sought in the Bid document, ATC and Corrigendum if any.

3. Past Project Experience

Proof for Past Experience and Project Experience clause: For fulfilling the experience criteria any one of the following documents may be considered as valid proof for meeting the experience criteria:a. Contract copy along with Invoice(s) with self-certification by the bidder that service/supplies against the invoices have been executed.b. Execution certificate by client with contract value.c. Any other document in support of contract execution like Third Party Inspection release note, etc.**Proof for Past Experience and Project Experience clause:** For fulfilling the experience criteria any one of the following documents may be considered as valid proof for meeting the experience criteria:a. Contract copy along with Invoice(s) with self-certification by the bidder that service/supplies against the invoices have been executed.b. Execution certificate by client with contract value.c. Any other document in support of contract execution like Third Party Inspection release note, etc.

4. Forms of EMD and PBG

Bidders can also submit the EMD with Account Payee Demand Draft in favour of

Security Paper Mill
payable at

Narmadapuram

Bidder has to upload scanned copy / proof of the DD along with bid and has to ensure delivery of hardcopy to the Buyer within 5 days of Bid End date / Bid Opening date.

5. Forms of EMD and PBG

Bidders can also submit the EMD with Fixed Deposit Receipt made out or pledged in the name of A/C (Name of the Buyer). The bank should certify on it that the deposit can be withdrawn only on the demand or with the sanction of the pledgee. For release of EMD, the FDR will be released in the favour of the bidder by the Buyer after making endorsement on the back of the FDR duly signed and stamped along with covering letter. Bidder has to upload scanned copy/ proof of the FDR along with bid and has to ensure delivery of hardcopy to the Buyer within 5 days of Bid End date/ Bid Opening date

6. Forms of EMD and PBG

Bidders can also submit the EMD with Banker's Cheque in favour of

Security Paper Mill
payable at
Narmadapuram

Bidder has to upload scanned copy / proof of the BC along with bid and has to ensure delivery of hardcopy to the Buyer within 5 days of Bid End date / Bid Opening date.

7. Forms of EMD and PBG

Successful Bidder can submit the Performance Security in the form of Account Payee Demand Draft also (besides PBG which is allowed as per GeM GTC). DD should be made in favour of

Security Paper Mill
payable at
Narmadapuram

. After award of contract, Successful Bidder can upload scanned copy of the DD in place of PBG and has to ensure delivery of hard copy to the original DD to the Buyer within 15 days of award of contract.

8. Forms of EMD and PBG

Successful Bidder can submit the Performance Security in the form of Fixed Deposit Receipt also (besides PBG which is allowed as per GeM GTC). FDR should be made out or pledged in the name of

Security Paper Mill, Narmadapuram
A/C (Name of the Seller). The bank should certify on it that the deposit can be withdrawn only on the demand or with the sanction of the pledgee. For release of Security Deposit, the FDR will be released in favour of bidder by the Buyer after making endorsement on the back of the FDR duly signed and stamped along with covering letter. Successful Bidder has to upload scanned copy of the FDR document in place of PBG and has to ensure delivery of hard copy of Original FDR to the Buyer within 15 days of award of contract.

9. Buyer Added Bid Specific ATC

Buyer Added text based ATC clauses

ADDITIONAL TERMS & CONDITIONS (ATC)

1. Required Terms of Delivery: F.O.R. Security Paper Mill Narmadapuram (Duly Unloaded).

2. Destination: Security Paper Mill, Narmadapuram (M.P.)-461005

3. Bidder Should Quote Prices Inclusive of GST And All Cost Components Such As Packing & Forwarding Details, Freight & Insurance Charges upto Destination etc. on FOR Security Paper Mill, Narmadapuram (Madh

ya Pradesh), India basis only.

4. Liquidated Damages (LD) Clause: If the contractor fails to deliver the goods and/or services or any installment thereof within the Delivery Period, SPM Narmadapuram shall, without prejudice to other rights and remedies available to SPM, Narmadapuram under the contract, deduct from the contract price, as Liquidated damages, a sum equivalent to the rate of 0.5 Percent of the delivered price of the delayed goods and/or services for each week of delay or part thereof until actual delivery or performance, subject to a maximum deduction of the 10% of the delayed goods or services.

5. The terms and conditions, guidelines of SPMCIL Procurement Manual Version 3.0 will be applicable to this bid at any stage to avoid any conflict at later stage. Kindly refer General Instructions to Tenderer (GIT) and General Conditions of Contract (GCC) of SPMCIL Procurement Manual Version 3.0 for additional terms and conditions as per the links given below:

GIT: <https://spmCIL.com/uploaddocument/GIT/new.pdf>

GCC: <https://spmCIL.com/uploaddocument/GCC/new.pdf>

6. SPM (as Buyer) is liable to deduct TDS u/s 194Q @ applicable rate on goods purchases (if applicable). In case of deduction of TDS under section 194Q; the Supplier (Vendor) need not to charge TCS u/s 206C (1H) on invoicing on or after 01.07.2021.

7. Vendor has to submit declaration in specified format (*refer Buyer added Specific ATC*) for the compliance of Section 206AB of Income Tax Act, 1961. In case of non-submission of declaration; TDS will be deducted at higher rates (as applicable) as per section 206AB.

8. GST Return: Supplier should file the GST returns for outward supplies in time. SPM reserves the right to withhold the payment of further supplies till production of evidence of filing of Returns.

9. Bidder shall submit duly seal & signed copy of Technical Specifications.

Warranty: - One year warranty from the date of Supply and Installation of material at HRD center at SPM, Narmadapuram.

Delivery Period: - 03 months for all material Supply and Installation at HRD center after issued of Purchase order/NAC.

Installation: Scope of Work includes commissioning of complete package.

Payment Terms: 100% payment for Supply and Installation of material at HRD center as per scope of work shall be made after successful production of all documents as per bid terms and condition by the firm. Payment shall be made through RTGS/NEFT.

10. Buyer Added Bid Specific ATC

Buyer uploaded ATC document [Click here to view the file.](#)

Disclaimer/अस्वीकरण

The additional terms and conditions have been incorporated by the Buyer after approval of the Competent Authority in Buyer Organization, whereby Buyer organization is solely responsible for the impact of these clauses on the bidding process, its outcome, and consequences thereof including any eccentricity / restriction arising in the bidding process due to these ATCs and due to modification of technical specifications and / or terms and conditions governing the bid. Any clause(s) incorporated by the Buyer regarding following shall be treated as null and void and would not be considered as part of bid:-

1. Definition of Class I and Class II suppliers in the bid not in line with the extant Order / Office Memorandum issued by DPIIT in this regard.
2. Seeking EMD submission from bidder(s), including via Additional Terms & Conditions, in contravention to exemption provided to such sellers under GeM GTC.
3. Publishing Custom / BOQ bids for items for which regular GeM categories are available without any Category item bunched with it.
4. Creating BoQ bid for single item.
5. Mentioning specific Brand or Make or Model or Manufacturer or Dealer name.
6. Mandating submission of documents in physical form as a pre-requisite to qualify bidders.
7. Floating / creation of work contracts as Custom Bids in Services.
8. Seeking sample with bid or approval of samples during bid evaluation process.
9. Mandating foreign / international certifications even in case of existence of Indian Standards without specifying equivalent Indian Certification / standards.
10. Seeking experience from specific organization / department / institute only or from foreign / export experience.
11. Creating bid for items from irrelevant categories.
12. Incorporating any clause against the MSME policy and Preference to Make in India Policy.
13. Reference of conditions published on any external site or reference to external documents/clauses.
14. Asking for any Tender fee / Bid Participation fee / Auction fee in case of Bids / Forward Auction, as the case may be.

Further, if any seller has any objection/grievance against these additional clauses or otherwise on any aspect of this bid, they can raise their representation against the same by using the Representation window provided in the bid details field in Seller dashboard after logging in as a seller within 4 days of bid publication on GeM. Buyer is duty bound to reply to all such representations and would not be allowed to open bids if he fails to reply to such representations.

This Bid is governed by the General Terms and Conditions/सामान्य नियम और शर्तें, conditions stipulated in Bid and Service Level Agreement specific to this Service as provided in the Marketplace. However in case if any condition specified in General Terms and Conditions/सामान्य नियम और शर्तें is contradicted by the conditions stipulated in Service Level Agreement, then it will over ride the conditions in the General Terms and Conditions.

In terms of GeM GTC clause 26 regarding Restrictions on procurement from a bidder of a country which shares a land border with India, any bidder from a country which shares a land border with India will be eligible to bid in this tender only if the bidder is registered with the Competent Authority. While participating in bid, Bidder has to undertake compliance of this and any false declaration and non-compliance of this would be a ground for immediate termination of the contract and further legal action

in accordance with the laws./जेम की सामान्य शर्तों के खंड 26 के संदर्भ में भारत के साथ भूमि सीमा साझा करने वाले देश के बिडर से खरीद पर प्रतिबंध के संबंध में भारत के साथ भूमि सीमा साझा करने वाले देश का कोई भी बिडर इस निविदा में बिड देने के लिए तभी पात्र होगा जब वह बिड देने वाला सक्षम प्राधिकारी के पास पंजीकृत हो। बिड में भाग लेते समय बिडर को इसका अनुपालन करना होगा और कोई भी गलत घोषणा किए जाने व इसका अनुपालन न करने पर अनुबंध को तत्काल समाप्त करने और कानून के अनुसार आगे की कानूनी कार्रवाई का आधार होगा।

---Thank You/धन्यवाद---

Scope of Work

Enlighten Desk Cum Bench N Seater

Providing, supplying and placing of desk & Bench. Enlighten is an ingenious product which provides an elegant, modular solution to the needs of modern day classroom. It offers flexibility in layout and efficiency in space management Without compromising on seating comfort. A)Legs: Legs are made of MS ERW tube section (157138) of size 75x25x2 mm thick oval tube with 5 mm thick HR brackets as per IS:2062 and 2mm thick CRCA brackets as per IS-513 welded on to the tubes. Assembly is powder coated with epoxy polyester. Leg height varies from 705 to 1005 in pitch of 50 as per layout. Sturdy anchoring by anchor bolts on to base of 8mm thick plate for proper resting of Leg**. Shoe made of ultramid -Nylon are provided at the bottom for covering the base plate. B)Side dads: Two side clads made of e18 mm thick plate with 0.8mm thick pvc lipping and on the outside covered with welded metal structure made of 2 mm thick CRCA as per IS-513 powder coated with Epoxy polyester. C)Worktop: Worktop are made of 25 mm thick Pre-Laminated Board of E1-P2 Grade and approved shade conforming to IS:12823:1990. All the edge of work surface are provided with machine pressed 2mm thick pvc edge band glued with hot melt glue. D)Seat: Seat has self-closing mechanism which will operate by means of dead weight. Seat under structure is made from combination of welded fabricated structure of 5mm Thick HR as per IS:2062 and 8mm thick ply as per IS:303 with moulded PU foam of density 55 kg/cu.mtr. on top which in turn is covered with stitched upholstery made of laterite as per INT/DSN/MSS/UPH1038 or foam back fabric as per TNT/DSN/MSS/UPH/013. Seat assembly is covered on bottom side by means of seat cover made of pp. E)Seat Back: Seat back is made from combination of 8mm thick ply as per IS:303 with moulded foam on top which in turn is covered with stitched upholstery made laterite as per INT/DSN/MSS/UPH/038 or foam back fabric as per INT/DSN/MSS/UPH/013. F) Seat Support Frame: Seat support frame is made from combination of MS ERW tube section (IS 7138) of size 80x40x2.5 mm thick rectangular tube and MS ERW tube section (IS 7138), of size 48x19.1x2 mm thick oval tube welded together. Assembly is powder coated with Epoxy polyester. CAP made of ultramid are provided from front to cover the oval tubes. G) Modesty: Modesty is made of 25mm thick pre-laminated twin board of E1-P2 Grade and approved shade conforming to IS:12823:1990. All the edge of modesty are provided with machine pressed 2 mm Thick pvc edge band glue with hot melt glue. Product to be certified with Indoor Advantage Gold.

Mingle Modular MEM_2STR MAIN APC

Providing, supplying and placing of conference Table. Work Surface-Made of 36mm thick MDF one side pre-laminate board conforming to IS14587: 1998 with 0.4mm PVC membrane pressed on to top and having chamfered edge. Plastic ABS access flap is provided for easy access to wires and cables. Work top is available in various shapes as shown above. Under structure-The Under-structure consists of mixture of 25mm and 18mm Pre-laminated twin board of E1-P2 grade and approved shade conforming to IS-12823:1990, Edge banded with matching 2 mm thick PVC lipping. Aluminium alloy 63400 - WP profile is used for connecting panels together. Modesty Panel-Made of 18mm Thick Pre-laminated twin board of E1-P2 grade and approved shade conforming to IS-12823:1990, Edge banded with matching 2 mm thick PVC lipping. Powder coated accent metal strip provided below work surface to enhance aesthetics. It is made of 0.8mm CRCA as per IS 513, epoxy polyester powder coated (DFT 40-60 microns). Wire Management-An array of panels made of 0.8mm CRCA MS IS:513, epoxy polyester powder coated (DFT 40-60 microns) is used for flow of wires and cables. Provision to mount Anchor Roma 6 module plate is provided below worktop. Cut-out on top with two piece injection moulded plastic part polymer component is fitted to pullout audio, video cables onto worktop and connect devices charger to power socket below worktop. Product to be certified with Indoor Advantage Gold, GRIHA & SVGRIHA, Greenpro & Greengaurd UL.

High Back Executive Metal Wheel Chair

Providing, supplying and placing of High Back Chair. SEAT/BACK ASSEMBLY : The Cushioned seat should be made of Injection molded Plastic outer & inner. Plastic Inner should be upholstered with leatherette and moulded High Resilience (HR) Polyurethane foam of Density 45 ± 2 kg/m³, and hardness load 16 ± 2 kgf as per IS:7888 for 25% compression. The Cushioned back should be made of PU Foam with insitu molded MS E.R.W Round Tube of size 1.9 ± 0.03 cm x 0.16 ± 0.0128 cm. It upholstered with Leatherette Seat SIZE : 47.0 cm. (W) x 48.0 cm. (D) HIGH BACK SIZE: 47.7 cm. (W) x 76.4 cm ARMRESTS : The armrest top should be moulded from polyurethane (PU) and mounted on to a drop lift adjustable type tubular armrest support made of 03.81 ± 0.03 cm x 0.2 ± 0.01 cm thk M.S. E.R.W tube having chrome plated finish. The armrest Providing, supplying and placing of High Back Chair. SEAT/BACK ASSEMBLY : The Cushioned seat should be made of Injection molded Plastic outer & inner. Plastic Inner should be upholstered with leatherette and moulded High Resilience (HR) Polyurethane foam of Density 45 ± 2 kg/m³, and hardness load 16 ± 2 kgf as per IS:7888 for 25% compression. The Cushioned

back should be made of PU Foam with insitu molded MS E.R.W Round Tube of size $1.9 \pm 0.03 \text{ cm} \times 0.16 \pm 0.0128 \text{ cm}$. It upholstered with Leatherette Seat SIZE : 47.0 cm. (W) x 48.0 cm. (D) HIGH BACK SIZE: 47.7 cm. (W) x 76.4 cm ARMRESTS : The armrest top should be moulded from polyurethane(PU) and mounted on to a drop lift adjustable type tubular armrest support made of $03.81 \pm 0.03 \text{ cm} \times 0.2 \pm 0.01 \text{ cm}$ thk M.S. E.R.W tube having chrome plated finish. The armrest height adjustable up to $6.5 \pm 0.5 \text{ cm}$ in 5 steps. ACTIVE BIO-SYNCHRO MECHANISM : The adjustable tilting mechanism should be designed with the following features: • 360° revolving type. • Front-pivot for tilt with feet resting on ground and continuous lumbar support ensuring more comfort. • Tilt tension adjustment can be operated in seating position. • 5-position Tilt limiter giving option of variable tilt angle to the chair. • Seat/back tilting ratio of 1: 2 • The mechanism housing should be made up of HPDC Aluminium black powder coated. SEAT DEPTH ADJUSTMENT : Seat depth adjustment should be integrated in the seat through a sliding mechanism. Seat depth adjustment range should be of $6.0 \pm 0.5 \text{ cm}$. ADJUSTABLE BACK SUPPORT: Back Frame should be connected to the Up/Dn mechanism housed in Plastic T spine. It can be adjusted in the range of $7.42 \pm 0.5 \text{ cm}$ for the comfortable back support to suit individual need. PNEUMATIC HT. ADJUSTMENT: The pneumatic ht adjustment has an adjustment stroke of $10.0 \pm 0.3 \text{ cm}$. PEDESTAL ASSEMBLY: The pedestal should be High Pressure Die cast polished Aluminium and fitted with 5 nos. twin wheel castors. The pedestal should be $65.0 \pm 0.5 \text{ cm}$. pitch-center dia. ($75.0 \pm 1.0 \text{ cm}$. With castors.) TWIN WHEEL CASTORS: The twin wheel castors should be injection moulded in black PP having $6.0 \pm 0.1 \text{ cm}$ wheel Diameter. t height adjustable up to $6.5 \pm 0.5 \text{ cm}$ in 5 steps. ACTIVE BIO-SYNCHRO MECHANISM : The adjustable tilting mechanism should be designed with the following features: • 360° revolving type. • Front-pivot for tilt with feet resting on ground and continuous lumbar support ensuring more comfort. • Tilt tension adjustment can be operated in seating position. • 5-position Tilt limiter giving option of variable tilt angle to the chair. • Seat/back tilting ratio of 1: 2 • The mechanism housing should be made up of HPDC Aluminium black powder coated. SEAT DEPTH ADJUSTMENT : Seat depth adjustment should be integrated in the seat through a sliding mechanism. Seat depth adjustment range should be of $6.0 \pm 0.5 \text{ cm}$. ADJUSTABLE BACK SUPPORT: Back Frame should be connected to the Up/Dn mechanism housed in Plastic T spine. It can be adjusted in the range of $7.42 \pm 0.5 \text{ cm}$ for the comfortable back support to suit individual need. PNEUMATIC HT. ADJUSTMENT: The pneumatic ht adjustment has an adjustment stroke of $10.0 \pm 0.3 \text{ cm}$. PEDESTAL ASSEMBLY: The pedestal should be High Pressure Die cast polished Aluminium and fitted with 5 nos. twin wheel castors. The pedestal should be $65.0 \pm 0.5 \text{ cm}$. pitch-center dia. ($75.0 \pm 1.0 \text{ cm}$. With castors.) TWIN WHEEL CASTORS: The twin wheel castors should be injection moulded in black PP having $6.0 \pm 0.1 \text{ cm}$ wheel Diameter. Product to be certified with Indoor Advantage Gold, GRIHA & SVGRIHA, Greenpro, Greengaurd UL & BIFMA LEVEL.

Mid Back Metal Wheel Chair

Providing, supplying and placing of Mid Back Chair. SEAT/BACK ASSEMBLY : The Cushioned seat should be made of Injection molded Plastic outer & inner. Plastic Inner should be upholstered with leatherette and moulded High Resilience (HR) Polyurethane foam of Density $45 \pm 2 \text{ kg/m}^3$, and hardness load $16 \pm 2 \text{ kgf}$ as per IS:7888 for 25% compression. The Cushioned back should be made of PU Foam with insitu molded MS E.R.W Round Tube of size $1.9 \pm 0.03 \text{ cm} \times 0.16 \pm 0.0128 \text{ cm}$. It upholstered with Leatherette. Seat SIZE : 47.0 cm. (W) x 48.0 cm. (D) MID BACK SIZE: 47.7 cm. (W) x 60.1 cm. (D) ARMRESTS (FU3301/FU3302) : The armrest top should be moulded from polyurethane(PU) and mounted on to a drop lift adjustable type tubular armrest support made of $03.81 \pm 0.03 \text{ cm} \times 0.2 \pm 0.01 \text{ cm}$ thk M.S. E.R.W tube having chrome plated finish. The armrest height adjustable up to $6.5 \pm 0.5 \text{ cm}$ in 5 steps. ACTIVE BIO-SYNCHRO MECHANISM (FU3301/FU3302): The adjustable tilting mechanism should be designed with the following features: • 360° revolving type. • Front-pivot for tilt with feet resting on ground and continuous lumbar support ensuring more comfort. • Tilt tension adjustment can be operated in seating position. • 5-position Tilt limiter giving option of variable tilt angle to the chair. • Seat/back tilting ratio of 1: 2 • The mechanism housing should be made up of HPDC Aluminium black powder coated. SEAT DEPTH ADJUSTMENT: Seat depth adjustment should be integrated in the seat through a sliding mechanism. Seat depth adjustment range should be of $6.0 \pm 0.5 \text{ cm}$. ADJUSTABLE BACK SUPPORT : Back Frame should be connected to the Up/Dn mechanism housed in Plastic T spine. It can be adjusted in the range of $7.42 \pm 0.5 \text{ cm}$ for the comfortable back support to suit individual need. PNEUMATIC HT. ADJUSTMENT : The pneumatic ht adjustment has an adjustment stroke of $10.0 \pm 0.3 \text{ cm}$. PEDESTAL ASSEMBLY: The pedestal should be High Pressure Die cast polished Aluminium and fitted with 5 nos. twin wheel castors. The pedestal should be $65.0 \pm 0.5 \text{ cm}$. pitch-center dia. ($75.0 \pm 1.0 \text{ cm}$. With castors.) TWIN WHEEL CASTORS: The twin wheel castors should be injection moulded in black PP having $6.0 \pm 0.1 \text{ cm}$ wheel Diameter. Product to be certified with Indoor Advantage Gold, GRIHA & SVGRIHA, Greenpro, Greengaurd UL & BIFMA LEVEL.

Low Mid Back Wheel Chair

Providing, supplying and placing of Low Mid Back Chair. SEAT/BACK ASSEMBLY: The seat and back are made up of $1.2 \pm 0.1 \text{ cm}$. thick hot-pressed plywood measured. upholstered with fabric upholstery covers and moulded

Polyurethane foam. The back foam is designed with contoured lumbar support for extra comfort. The seat has extra thick foam on front edge to give comfort to popliteal area. MID BACK SIZE 47.5 cm. (W) x 58.0 cm. (H). SEAT SIZE 47.0 cm. (W) x 48.0 cm. (D) HIGH RESILIENCE (HR) POLYURETHANE FOAM: The HR polyurethane foam is moulded with density = 45 ± 2 kg/m³ and hardness load 16 ± 2 kgf as per IS:7888 for 25% compression. ARMRESTS: The one-piece armrests are injection moulded from black Co-polymer Polypropylene. CENTER TILT SYNCHRO MECHANISM : The mechanism is designed with the following features: •360° revolving type. Upright position locking • Tilt tension adjustment. •Seat/back tilting ratio of 1:3. TUBULAR FRAME : The powder coated (DFT 40-60 microns) tubular frame is cantilever type & made of \varnothing 2.54 \pm 0.03cm. x 0.2 \pm 0.016cm.thk. M.S. ER.W. Tube. PNEUMATIC HEIGHT ADJUSTMENT : The pneumatic height adjustment has an adjustment stroke of 12.0 \pm 0.3cm. TELESCOPIC BELLOW ASSEMBLY : The bellow is 3-piece telescopic type and injection moulded in black Polypropylene. PEDESTAL ASSEMBLY : The pedestal is injection moulded in black 33%glass-filled Nylon and fitted with 5 nos. twin wheel castors. The pedestal is 66.3 \pm 0.5cm. pitch-centre dia. (76.3 \pm 1.0cm with castors). TWIN WHEEL CASTORS (FOR 9U01RG/9U02RG): The twin wheel castors are injection moulded in Black Nylon. Product to be certified with Indoor Advantage Gold, GRIHA & SVGRIHA, Greenpro.

Note:- Product to be certified with Indoor Advantage Gold, GRIHA & SVGRIHA, Greenpro and BIFMA or Indian equivalent certification.

1. **Enlighten Desk cum Bench N Seater, Quantity- 70 nos.**



2. **Mingle modular mem_2 STR Main apc, Quantity- 05 nos.**



3. High Back Executive metal wheel Chair, Quantity- 01 nos.



4. Mid back metal wheel Chair, Quantity- 04 nos.



5. **Low Mid back wheel Chair, Quantity- 02 nos.**



Payment Terms: 100% payment for Supply and Installation of material at HRD center as per scope of work shall be made after successful FAT and production of all documents as per bid terms and condition by the firm. Payment shall be made through RTGS/NEFT.

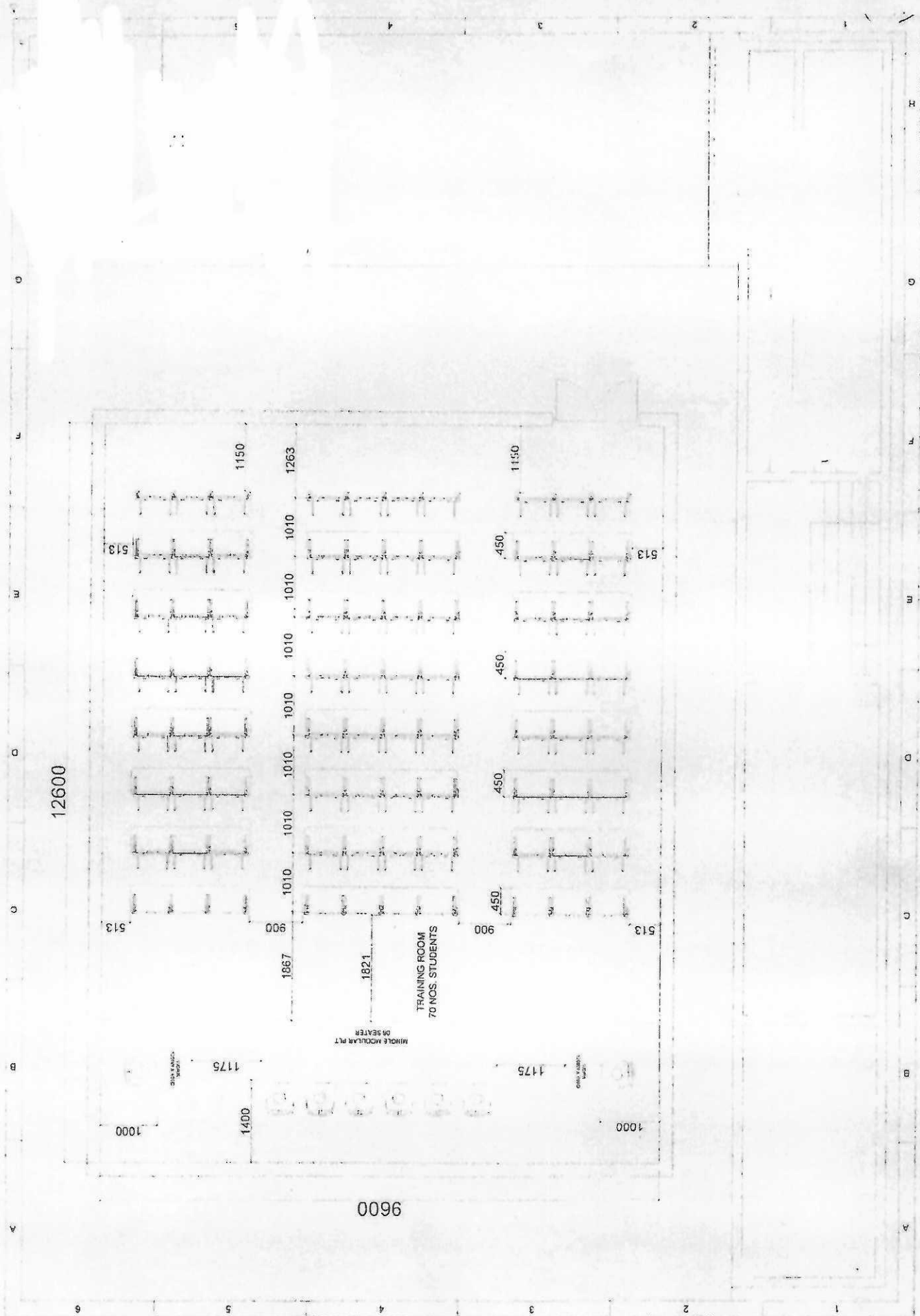

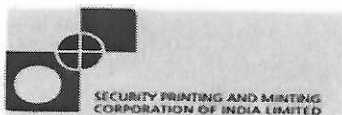

Section XI: Price Schedule

OFFER FOR TENDER NO Date of opening.....Time.....Hours
We..... hereby certify that we are established firm of manufacturers / authorised agents of M/s.....with factories
 at..... which are fitted with modern equipment and where the production methods, quality control and testing of all materials and
 parts manufactured or used by us are open to inspection by the representative of.....(Name of Purchaser). We hereby offer to supply
 the following items at the prices indicated below:

The Price bid should clearly indicate the break-up of the price as under:-

SN		Item No. 10	Item No. 20	Item no. 30	Item no. 40	Item no. 50
	Material Description	Enoighten Desk Cum Bench N Seater	Mingle Modular MEM_2 Seater Main APC	High Back Executive Metal Wheel Chair	Mid Back Metal Wheel Chair	Low Mid Back Wheel Chair
	GSTIN No.					
	SAC Code					
1	Basic Price per unit upto F.O.R. SPM, Narmapuram (as per Section VII)					
2	Quantity	70	5	1	4	2
	Unit	Pcs	Pcs	Pcs	Pcs	Pcs
3	Other taxes/charges (if any) Please specify					
4	TOTAL (1 X 2)+3					
5	GST in % only on 4					
6	Total price Service of SPM, Narmapuram (in figures only) (4+5) Rs.					
7	Total price Service of SPM, Narmapuram (in Word only)					

NOTE:

The method of evaluation of L1 bidder for awarding the Contract shall be on consolidated offered total price as per
 Section – XI (Price schedule) of this tender document.

1. Scope of Supply: (Cost break-up of the quoted cost, showing inter-alia costs of all the concomitant Installation/
 Commissioning/ Training/ Technical Support/ incidental services/ software/ accessories, considered necessary to make the
 proposal self-contained and complete must be indicated here.)

2. Taxation Details:

- PAN number.....
- Type of GST Registration (Registered, Unregistered, Composition, SEZ, RCM etc.)
- GSTIN number.....
- Registered Address as per GST registration and Place of Delivery for GST Purpose
- Contact Names, Nos. & email IDs for GST matters (Please mention primary and secondary

3. It is hereby certified that we have understood the General and Special Instructions to Tenderers (GIT and SIT), and also
 the General and Special Conditions of Contract (GCC and SCC) attached to the tender and have thoroughly examined
 specifications/ Quality Control Requirements and other stipulations in Section VII & VIII– Technical Specifications and
 Quality Control Requirements; and are thoroughly aware of the nature of stores required and our offer is to supply stores
 strictly in accordance with the requirements and according to the terms of the tender. We agree to abide solely by the
 General and Special Conditions of Contract and other conditions of the tender in accordance with the tender documents if
 the contract is awarded to us.

4. We hereby offer to supply the stores detailed above or such portion thereof, as you may specify in the acceptance of
 tender at the price quoted and agree to hold this offer open for acceptance for a period of ---- days from the date of
 opening of tender (i.e., upto -----). We shall be bound by the communication of acceptance dispatched within the
 prescribe time.

5. Earnests Money/Bid Guarantee for an amount equal to is enclosed in form of -----{form and
 reference number, date) as per the Tender Documents.

Dated.....

Signature and seal of Manufacturer/Bidder

Note: (i) The Bidder may prepare their own offer forms as per this proforma. (ii) No change in the proforma is
 permissible. (iii) No erasures or alternations in the text of the offer are permitted. Any correction made in the offer shall
 be initialed by the bidder. (iv) This Section should not bring in any new Technical Parameter that has not been mentioned
 in the Technical Bid.

NOTE : 'BIDDER TO FURNISH STIPULATED DOCUMENTS ALONG WITH TENDER IN SUPPORT OF FULFILLMENT OF TENDER CRITERIA. FURTHER
 CORRESPONDENCE IN THIS REGARD WILL NOT BE ENTERTAINED FOR ANY REASON. NON-SUBMISSION OR INCOMPLETE SUBMISSION OF
 DOCUMENTS MAY LEAD TO REJECTION OF OFFER.

SIGNATURE OF BIDDER
 (WITH NAME, DESIGNATION AND SEAL)

ANNEXURE-I**Declaration for Section 206AB of TDS under income tax Act, 1961***(to be submitted on Letter Head)*

Vendor Code: _____

M/s _____

PAN _____

GSTIN _____

I/We _____ (Legal Name and complete address) _____, PAN:

_____ (PAN no) _____, TAN: _____ (TAN no.)

_____, referring to the provisions of 206AB of the IT Act, 1961, hereby declare the following:-

Financial Year	Aggregate TDS & TCS credit in our name was Rs. 50,000 or more ("Yes/ No")	Income Tax Return ("ITR") Filed ("Yes/No")	E-filing Acknowledgment Number (15 digit - numeric) (Attach copy of acknowledgments)	Date of Filing of Return of Income u/s 139(1) (DD/MM/YYYY)	Linked PAN with Aadhaar number or will link it before 30 Jun 2022 (or any further date as may be notified by CBDT ("Yes / No"))
2021-22					
2022-23					

We do hereby declare that to the best of my /our knowledge and belief what is stated above is correct, complete and is truly stated. In case there is a tax liability, interest or penal consequences which are levied on SPM on account of the false representation/ declaration, I/we undertake to fully indemnify SPM for the same.

FOR _____

Authorized Signatory

Date:

Note: In case the vendor failed to comply with the above provisions, TDS shall be deducted at the higher of the following rates, namely: -

- (i) at twice the rate specified in the relevant provision of the Act; or
- (ii) at twice the rate or rates in force; or
- (iii) at the rate of five per cent (5%).

(To be submitted on the Letter Head)

DECLARATION

We do hereby declare that,

1. We have not been blacklisted/debarred by BNPMIPL/BRBNMPL/SPMCIL or any Govt. Departments for participation in tenders. The information provided above is correct and true to the best of my knowledge and belief.
2. We do hereby declare that we have read and understood all terms and conditions of tender document including GIT, SIT, GCC, SCC, Technical Specification, Quality Control Criteria and confirm to abide to those conditions without any counter conditions.
3. We are accepting all the terms and condition as per Buyer Added Bid Specific ATC (Acceptance of Gem Bid).
4. We are accepting all the terms and conditions of the tender document without any deviation and withdraw all deviations if any.

Signature.....

Name.....

Designation.....

Date.....

Stamp of the Organization.....

ANNEXURE-III

(To be submitted on the Letter Head)

**DECLARATION
(Refer GIT Clause No.3.5)**

"I have read the clause regarding restrictions on procurement from a bidder of a country which shares a land border with India. I certify that M/s..... (Firm's name) is not from such a country or, if from such a country, has been registered with the Competent Authority. I hereby certify that M/s..... (Firm's name) fulfils at requirements in this regard and is eligible to be considered." (Where applicable, evidence of valid registration by the competent Authority shall be attached)"

I, the undersigned, declare that the item originates in..... (Name of the country).

Signature.....

Name.....

Designation.....

Date.....

Stamp of the Organization.....

(To be submitted on the letter head of the manufacturing firm)

SECTION XIV: MANUFACTURER'S AUTHORIZATION FORM

To,

Security Paper Mill, Narmadapuram
A Unit of Security Printing & Minting
Corporation of India Limited
(Wholly Owned by Govt. of India)
Hoshangabad

Ref: Your Tender document No, dated

We,.....who are proven and reputable manufacturers of
..... (Name and description of the goods offered in the tender) having
factories at hereby authorize Messrs
(name and address of the agent) to submit a tender, process the same further and enter into a
contract with you against your requirement as contained in the above referred tender enquiry
documents for the above goods manufactured by us.

We further confirm that no supplier or firm or individual other than Messrs.....
..... (name and address of the above agent) is authorized to submit a
tender, process the same further and enter into a contract with you against your requirement
as contained in the above referred tender enquiry documents for the above goods
manufactured by us.

We also hereby extend our full warranty, as applicable as per clause 16 of the General
Conditions of Contract read with modification, if any, in the Special Conditions of Contract for
the goods and services offered for supply by the above firm against this tender document.

Yours faithfully,

.....
.....

[Signature with date, name, and designation]

for and on behalf of Messrs.....

Name & address of the manufacturers

*Note: This letter of authorization should be on the letter head of the manufacturing firm and
should be signed by a person competent and having the power of attorney to legally bind the
manufacturer.*

Checklist of Documents for Technical Bid

S. No.	Documents Required	Submitted (✓)
1	Weather applied for MSME (MSME certificate)	()
2	Certificate of Local Content as per Public Procurement (Preference to Make in India), Order 2017	()
3	Duly Seal & Signed : Technical Specification (Scope of work)	()
4	Buyer added Specific ATC Declarations (Buyer uploaded ATC document : Annexure-I, II & III)	()
5	Manufacturer/OEM Authorization Certificate	()
6	Product to be certified with Indoor Advantage Gold, GRIHA & SVGRIHA, Greenpro and BIFMA or Indian equivalent certification	()